

- \* Please DO cut off power to avoid electric shock and endanger life safety before installation
- \* Installation height should be higher than 1.2m.
- \* For pole mounting, please complete wiring at the accessible hand-hole on the pole.

**Top Section: Standard Lamp Post Installation**

**Components:** Light sensor cover, Adjustable power screw plug, Screw 1/2-13, Screw 3/8-16\*1, Lamp post.

**Steps:**

1. Connect the wires correctly and insulate them.
2. Insert the lamp post into the lamp and tighten the screw.
3. Open the power adjustment screw plug and adjust to the desired power.
4. Remove the light sensor cover if you need the light sensor function.

**Legend:** Black--L, White--N, Green--GND.

**Bottom Section: Dead Plate Installation**

**Components:** Light sensor cover, Adjustable power screw plug, Spring washer, Flat gasket, Screw 7/16-14\*2, Screw 1/2-13, Dead plate, Lamp post.

**Steps:**

1. Connect the wires of the lamps and lamp poles, and do a good job of insulation.
2. Attach the lamp to the pole and lock the screws.
3. Open the power adjustment screw plug and adjust to the desired power.
4. Remove the light sensor cover if you need the light sensor function.

**Light Sensor Cover Dimensions (Unit:mm):**

- Overall width: 122
- Overall height: 55
- Mounting hole diameter:  $\phi 12$
- Mounting hole spacing: 77.3
- Mounting hole diameter:  $\phi 10$
- Mounting hole spacing: 109
- Mounting hole diameter:  $\phi 8$
- Mounting hole spacing: 18
- Mounting hole diameter:  $\phi 6$
- Mounting hole spacing: 55
- Mounting hole diameter:  $\phi 4$
- Mounting hole spacing: 18

180°

Light sensor cover

Adjustable power screw plug

90°

Remove the light sensor cap to activate the light sensor

1. Connect lamps and poles with wires and insulate then.
2. Insert the lamp into the lamp post and tighten the screw to secure the lamp to the lamp post.
3. Open the power adjustment screw plug and adjust to the desired power.  
If you need light sensor, please remove the light sensor cover.

Light sensor cover

Adjustable power screw plug

Spring washer

Flat gasket

Screw 7/16-14\*2

Flat rubber gasket

Dead plate

Black--L  
White--N  
Green--GND

Lamp post

Remove the light sensor cap to activate the light sensor

180°

1. Connect lamps and poles with wires and insulate then.
2. Insert the lamp into the lamp post and tighten the screw to secure the lamp to the lamp post.
3. Open the power adjustment screw plug and adjust to the desired power.

If you need light sensor. please remove the light sensor cover.

Unit:mm

199  
115  
97  
52  
85  
20  
125  
100

Light sensor cover

Adjustable power screw plug

Spring washer

Flat gasket

Screw 7/16-14\*2

Arc rubber gasket

Dead plate

Black--L  
White--N  
Green--GND

Lamp post

Remove the light sensor cap to activate the light sensor

180°

**All in one (Round & Square)**

## Page 1 of 2

## Trunnion

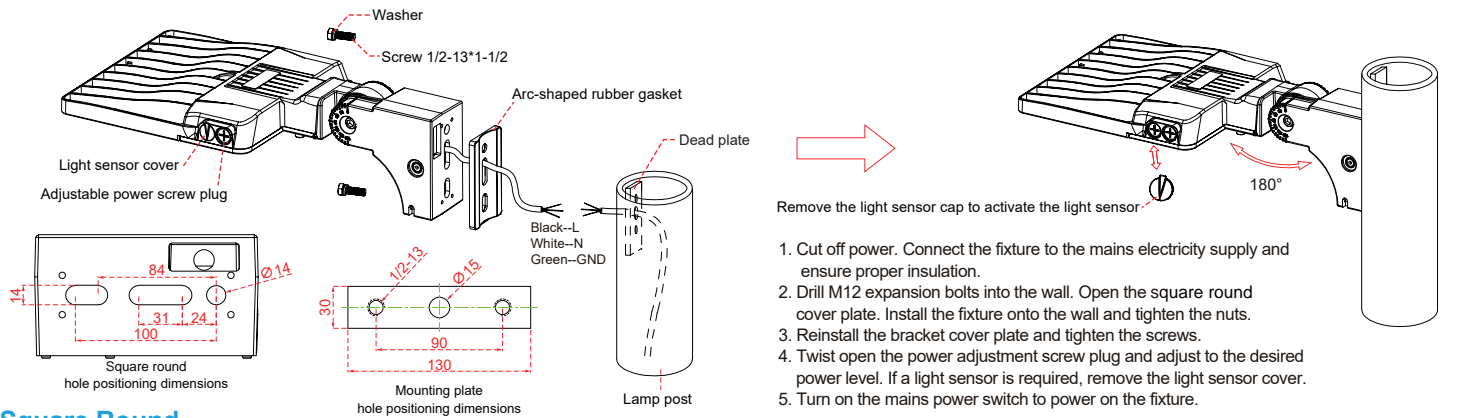
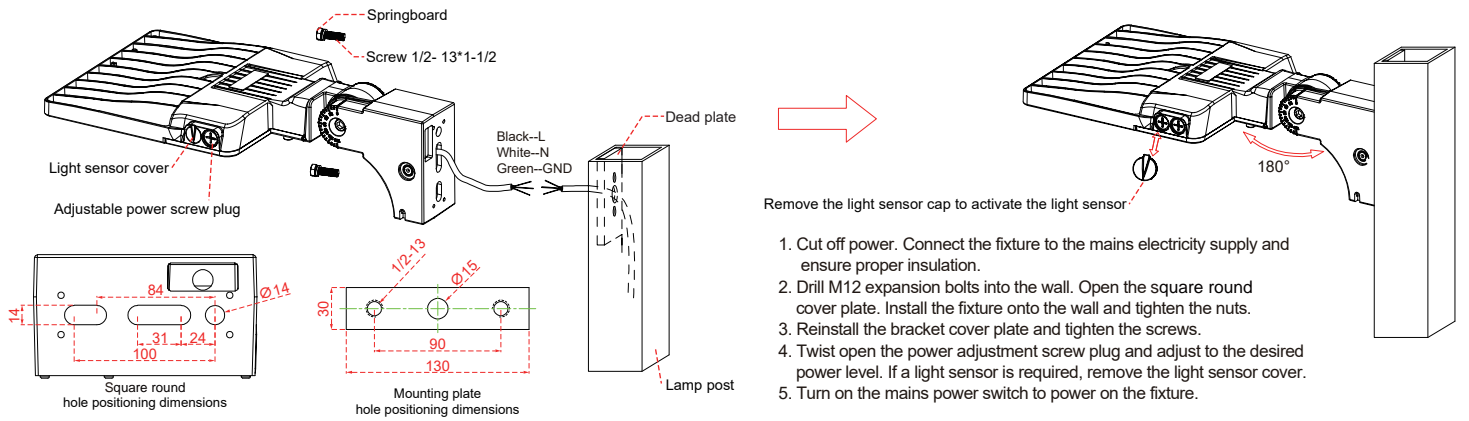
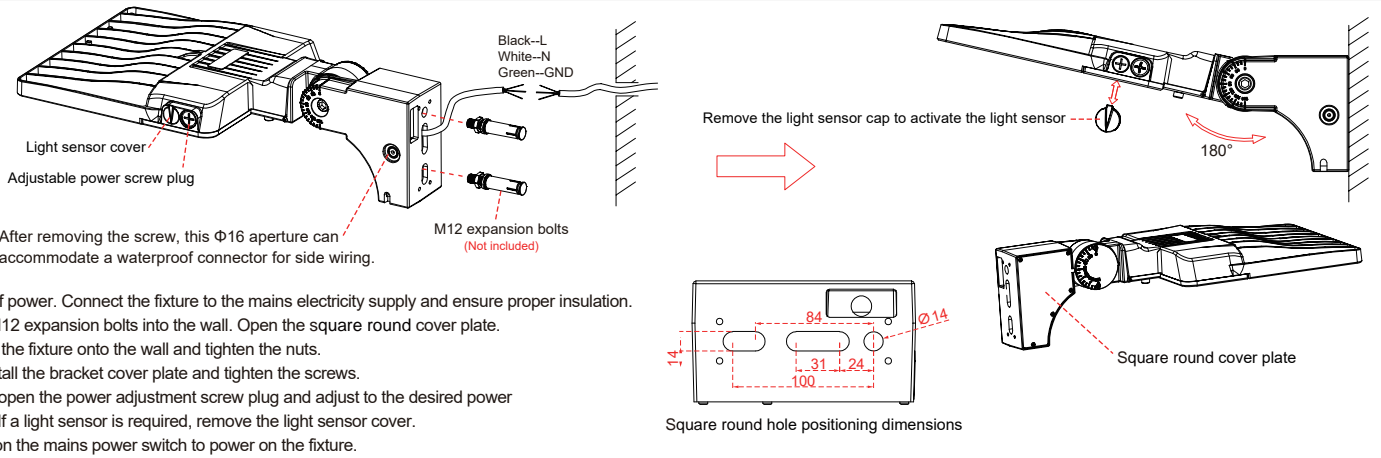
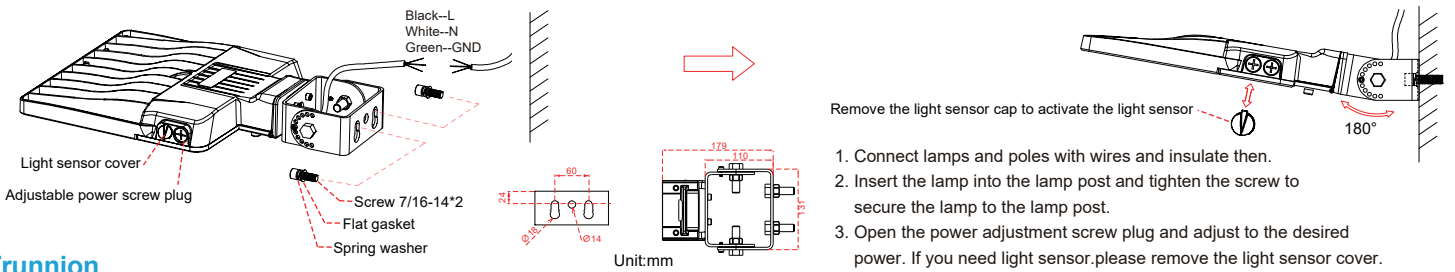

## Square Round

## Power Selections:

### Power Selections:

There are power options (L/M/H), please select the power according to your needs.  
Warning Turn off the lamp when adjusting the power to: avoid damage to the lamp.

	L	M	H
PL-100W	60W	80W	100W
PL-150W	90W	120W	150W
PL-200W	120W	160W	200W
PL-240W	144W	192W	240W
PL-320W	192W	256W	320W
PL-350W	210W	280W	350W

There are power options (L/M/H), please select the power according to your needs.

\* **WARNING:** Turn off the lamp when adjusting the power to avoid damage to the lamp.

